

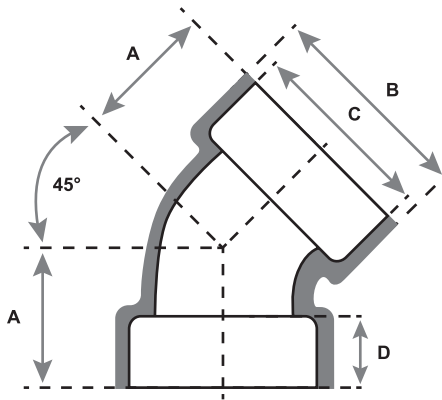

Republic Brass Sales, Inc.
 619.229.8304
 6566 Federal Blvd
 Lemon Grove, CA 91945
 www.republicbrasssales.com

45° ELBOW SOCKET WELD

Specification: ASME B16.11
 Pressure Rating: 3000 / 6000 PSIG (WOG)



**AVAILABLE ALLOYS: (FERROUS) CARBON STEEL (A105) & STAINLESS STEEL (GRADES 304 / 316 / 321 / 347)
 (NON-FERROUS) CUNI (90/10 & 70/30), NICU (MONEL), ALUMINUM (5086)**
**Additional materials available upon request.*

CLASS 3000												
NOMINAL PIPE SIZE	1/8"	1/4"	3/8"	1/2"	3/4"	1"	1 1/4"	1 1/2"	2"	2 1/2"	3"	4"
RBS P/N	4XSW3-020	4XSW3-040	4XSW3-060	4XSW3-100	4XSW3-150	4XSW3-200	9XSW3-250	4XSW3-300	4XSW3-400	4XSW3-450	4XSW3-500	4XSW3-600
A	0.750	0.750	0.750	1.000	1.125	1.250	1.313	1.375	1.750	2.063	2.500	3.125
B	0.906	0.906	1.063	1.313	1.563	1.844	2.219	2.500	3.031	4.000	4.375	6.000
C	0.420	0.555	0.690	0.855	1.065	1.330	1.675	1.915	2.406	2.906	3.535	4.545
D	0.375 (MIN.)	0.375 (MIN.)	0.375 (MIN.)	0.375 (MIN.)	0.5 (MIN.)	0.5 (MIN.)	0.5 (MIN.)	0.5 (MIN.)	0.625 (MIN.)	0.625 (MIN.)	0.625 (MIN.)	0.75 (MIN.)

CLASS 6000												
NOMINAL PIPE SIZE	1/8"	1/4"	3/8"	1/2"	3/4"	1"	1 1/4"	1 1/2"	2"	2 1/2"	3"	4"
RBS P/N	4XSW6-020	4XSW6-040	4XSW6-060	4XSW6-100	4XSW6-150	4XSW6-200	4XSW6-250	4XSW6-300	4XSW6-400	4XSW6-450	4XSW6-500	4XSW6-600
A	0.750	0.750	1.000	1.125	1.250	1.313	1.375	1.750	1.844	2.063	2.500	3.125
B	0.906	1.063	1.313	1.563	1.844	2.219	2.500	3.031	3.375	4.000	4.750	6.000
C	0.420	0.555	0.690	0.855	1.065	1.330	1.675	1.915	2.406	2.906	3.535	4.545
D	0.375 (MIN.)	0.375 (MIN.)	0.375 (MIN.)	0.375 (MIN.)	0.5 (MIN.)	0.5 (MIN.)	0.5 (MIN.)	0.5 (MIN.)	0.625 (MIN.)	0.625 (MIN.)	0.625 (MIN.)	0.75 (MIN.)

NOTES: Fittings may be ordered with reduced ends.

For P/N's replace X with the following codes:

Carbon Steel - CS	Stainless Steel 321 - 321	Cuni 70/30 - 7
Stainless Steel 304 - 304	Stainless Steel 347 - 347	Nicu (Monel) - M
Stainless Steel 316 - 316	Cuni 90/10 - 9	Aluminum Gr. 5086 - A

