

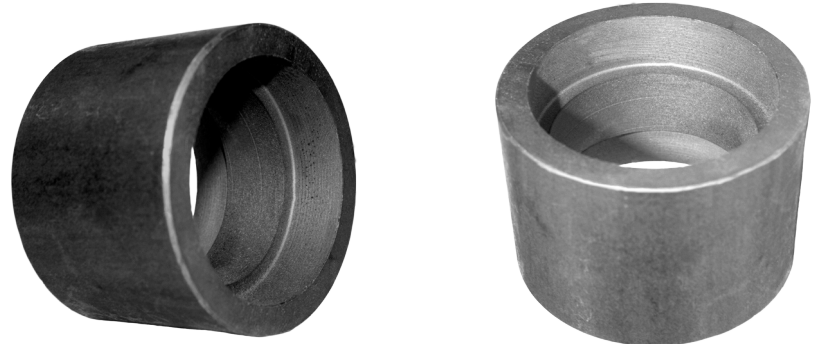

Republic Brass Sales, Inc.
 619.229.8304
 6566 Federal Blvd
 Lemon Grove, CA 91945
 www.republicbrasssales.com

COUPLING SOCKET WELD

Specification: ASME B16.11
 Pressure Rating: 3000 / 6000 PSIG (WOG)

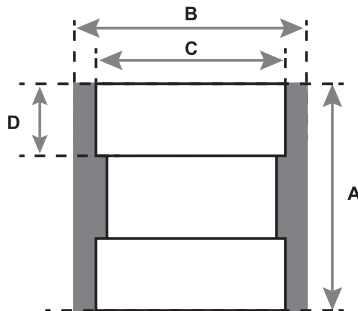

AVAILABLE ALLOYS: (FERROUS) CARBON STEEL (A105) & STAINLESS STEEL (GRADES 304 / 316 / 321 / 347)
 (NON-FERROUS) CUNI (90/10 & 70/30), NICU (MONEL), ALUMINUM (5086)

**Additional materials available upon request.*

CLASS 3000												
NOMINAL PIPE SIZE	1/8"	1/4"	3/8"	1/2"	3/4"	1"	1 1/4"	1 1/2"	2"	2 1/2"	3"	4"
RBS P/N	COXSW3-020	COXSW3-040	COXSW3-060	COXSW3-100	COXSW3-150	COXSW3-200	COXSW3-250	COXSW3-300	COXSW3-400	COXSW3-450	COXSW3-500	COXSW3-600
A	1.031	1.031	1.031	1.188	1.406	1.516	1.516	1.516	2.016	2.016	2.016	2.266
B	0.750	0.875	1.063	1.250	1.500	1.813	2.250	2.500	3.000	3.625	4.313	5.500
C	0.420	0.555	0.690	0.855	1.065	1.330	1.675	1.915	2.406	2.906	3.535	4.545
D	0.375 (MIN.)	0.375 (MIN.)	0.375 (MIN.)	0.375 (MIN.)	0.500 (MIN.)	0.500 (MIN.)	0.500 (MIN.)	0.500 (MIN.)	0.625 (MIN.)	0.625 (MIN.)	0.625 (MIN.)	0.75 (MIN.)

CLASS 6000												
NOMINAL PIPE SIZE	1/8"	1/4"	3/8"	1/2"	3/4"	1"	1 1/4"	1 1/2"	2"	2 1/2"	3"	4"
RBS P/N	COXSW6-020	COXSW6-040	COXSW6-060	COXSW6-100	COXSW6-150	COXSW6-200	COXSW6-250	COXSW6-300	COXSW6-400	COXSW6-450	COXSW6-500	COXSW6-600
A	1.063	1.125	1.125	1.156	1.406	1.516	1.516	1.516	2.016	2.016	2.016	2.266
B	0.875	1.063	1.313	1.500	1.750	2.250	2.500	3.000	3.625	4.250	5.000	6.250
C	0.420	0.555	0.690	0.855	1.065	1.330	1.675	1.915	2.406	2.906	3.535	4.545
D	0.375 (MIN.)	0.375 (MIN.)	0.375 (MIN.)	0.375 (MIN.)	0.500 (MIN.)	0.500 (MIN.)	0.500 (MIN.)	0.500 (MIN.)	0.625 (MIN.)	0.625 (MIN.)	0.625 (MIN.)	0.75 (MIN.)

NOTES: Fittings may be ordered with reduced ends.

For P/N's replace X with the following codes:

Carbon Steel - **CS**

Stainless Steel 321 - **321**

Cuni 70/30 - **7**

Stainless Steel 304 - **304**

Stainless Steel 347 - **347**

Nicu (Monel) - **M**

Stainless Steel 316 - **316**

Cuni 90/10 - **9**

Aluminum Gr. 5086 - **A**

