



Republic Brass Sales, Inc.  
 619.229.8304  
 6566 Federal Blvd  
 Lemon Grove, CA 91945  
 www.republicbrasssales.com

# CAP BUTT WELD

Specification: NAVSEA DWG 810-1385880  
 Pressure Rating: 200 PSIG (WOG)

Intended for use with Class 200  
 Copper Nickel Tube IAW MIL-T-16420

SERVICE RATING TABLE		
Nominal Pipe Size (INCHES)	Maximum Working Pressure (LB/IN <sup>2</sup> )	Maximum Temperature (°F)
1/4 through 12	200	150



90/10 CUNI  
 (ALLOY C70600)



70/30 CUNI  
 (ALLOY C71500)

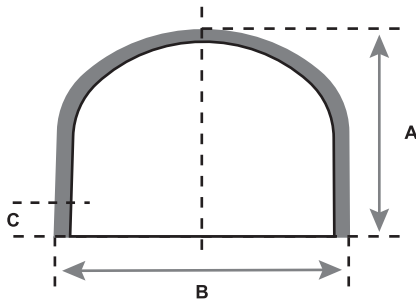

## AVAILABLE ALLOYS: CUNI 90/10 & CUNI 70/30

NOMINAL PIPE SIZE	RBS P/N (90/10)	RBS P/N (70/30)	A	B	C MIN
1"	CA9BW200	CA7BW200	1.50	1.315	0.50
1 1/4"	CA9BW250	CA7BW250	1.50	1.660	0.56
1 1/2"	CA9BW300	CA7BW300	1.50	1.900	0.69
2"	CA9BW400	CA7BW400	1.50	2.375	0.72
2 1/2"	CA9BW450	CA7BW450	1.50	2.875	0.88
3"	CA9BW500	CA7BW500	2.00	3.500	0.91
3 1/2"	CA9BW550	CA7BW550	2.50	4.000	0.94
4"	CA9BW600	CA7BW600	2.50	4.500	0.97
5"	CA9BW700	CA7BW700	3.00	5.563	1.09
6"	CA9BW800	CA7BW800	3.50	6.625	1.17
8"	CA9BW900	CA7BW900	4.00	8.625	1.38
10"	CA9BW1000	CA7BW1000	5.00	10.750	1.56
12"	CA9BW1100	CA7BW1100	6.00	12.750	1.69

NOTES: Fittings may be ordered with reduced ends.  
 Sizes not shown may be available upon request.

### EDGE PREPARATION FOR WELDING

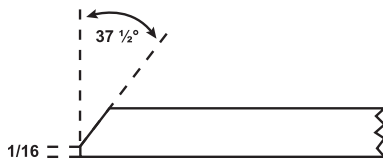

Square edge for 0.095 wall or lighter.  
 For heavier than 0.095 wall, beveled as shown.

