



Republic Brass Sales, Inc.
 619.229.8304
 6566 Federal Blvd
 Lemon Grove, CA 91945
 www.republicbrasssales.com

LATERAL BUTT WELD

Specification: NAVSEA DWG 810-1385880
 Pressure Rating: 200 PSIG (WOG)

Intended for use with Class 200
 Copper Nickel Tube IAW MIL-T-16420

SERVICE RATING TABLE		
Nominal Pipe Size (INCHES)	Maximum Working Pressure (LB/IN ²)	Maximum Temperature (°F)
1/4 through 12	200	150

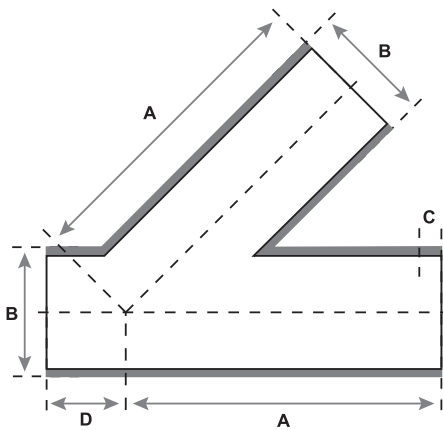

90/10 CUNI
 (ALLOY C70600)



70/30 CUNI
 (ALLOY C71500)

AVAILABLE ALLOYS: CUNI 90/10 & CUNI 70/30

NOMINAL PIPE SIZE	RBS P/N (90/10)	RBS P/N (70/30)	A	B	C MIN	D
1 1/4"	L9BW250	L7BW250	6.25	1.660	0.56	1.75
1 1/2"	L9BW300	L7BW300	7.00	1.900	0.69	2.00
2"	L9BW400	L7BW400	8.00	2.375	0.72	2.50
2 1/2"	L9BW450	L7BW450	9.50	2.875	0.88	2.50
3"	L9BW500	L7BW500	10.00	3.500	0.91	3.00
3 1/2"	L9BW550	L7BW550	11.50	4.000	0.94	3.00
4"	L9BW600	L7BW600	12.00	4.500	0.97	3.00
5"	L9BW700	L7BW700	13.50	5.563	1.09	3.50
6"	L9BW800	L7BW800	14.50	6.625	1.17	3.50
8"	L9BW900	L7BW900	17.50	8.625	1.38	4.50
10"	L9BW1000	L7BW1000	20.50	10.750	1.56	5.00
12"	L9BW1100	L7BW1100	24.50	12.750	1.69	5.50

EDGE PREPARATION FOR WELDING

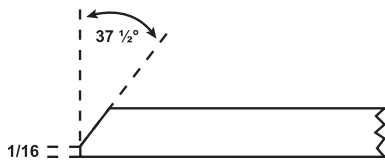

Square edge for 0.095 wall or lighter.
 For heavier than 0.095 wall, beveled as shown.

NOTES: Fittings may be ordered with reduced ends. Sizes not shown may be available upon request.

