



Republic Brass Sales, Inc.  
 619.229.8304  
 6566 Federal Blvd  
 Lemon Grove, CA 91945  
 www.republicbrasssales.com

# RETURN BEND BUTT WELD

Specification: NAVSEA DWG 810-1385880  
 Pressure Rating: 200 PSIG (WOG)

Intended for use with Class 200  
 Copper Nickel Tube IAW MIL-T-16420

SERVICE RATING TABLE		
Nominal Pipe Size (INCHES)	Maximum Working Pressure (LB/IN <sup>2</sup> )	Maximum Temperature (°F)
1/4 through 12	200	150



90/10 CUNI  
 (ALLOY C70600)



70/30 CUNI  
 (ALLOY C71500)

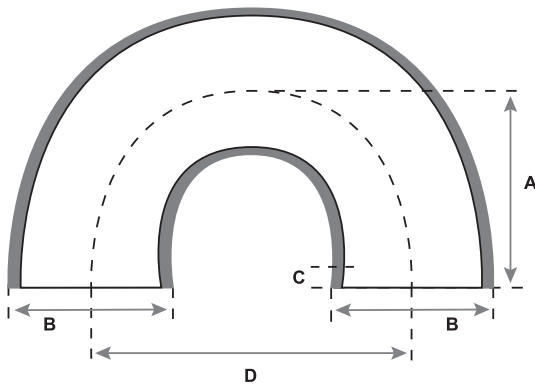

## AVAILABLE ALLOYS: CUNI 90/10 & CUNI 70/30

NOMINAL PIPE SIZE	RBS P/N (90/10)	RBS P/N (70/30)	A	B	C MIN	D
1"	RB9BW200	RB7BW200	2.00	1.315	0.50	3.00
1 1/4"	RB9BW250	RB7BW250	2.44	1.660	0.56	3.75
1 1/2"	RB9BW300	RB7BW300	2.94	1.900	0.69	4.50
2"	RB9BW400	RB7BW400	3.72	2.375	0.72	6.00
2 1/2"	RB9BW450	RB7BW450	4.63	2.875	0.88	7.50
3"	RB9BW500	RB7BW500	5.41	3.500	0.91	9.00
3 1/2"	RB9BW550	RB7BW550	6.25	4.000	0.94	10.50
4"	RB9BW600	RB7BW600	6.97	4.500	0.97	12.00
5"	RB9BW700	RB7BW700	8.59	5.563	1.09	15.00
6"	RB9BW800	RB7BW800	10.17	6.625	1.17	18.00
8"	RB9BW900	RB7BW900	13.38	8.625	1.38	24.00
10"	RB9BW1000	RB7BW1000	16.56	10.750	1.56	30.00
12"	RB9BW1100	RB7BW1100	19.69	12.750	1.69	36.00

### EDGE PREPARATION FOR WELDING

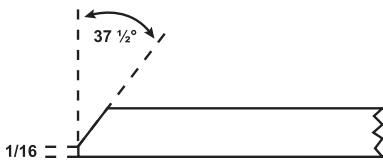

Square edge for 0.095 wall or lighter.  
 For heavier than 0.095 wall, beveled as shown.

NOTES: Fittings may be ordered with reduced ends. Sizes not shown may be available upon request.

