



Republic Brass Sales, Inc.  
 619.229.8304  
 6566 Federal Blvd  
 Lemon Grove, CA 91945  
 www.republicbrasssales.com

# STRAIGHT LINE BALL VALVE SIZES 4" to 6"

Specification: NAVSEA DWG 803-5001004

Pressure Rating: 400 PSI

VALVE ASSEMBLY NUMBER (DWG No.) 803-5001004 - A 3 1 1

MATERIAL (SEE A)  
 SIZE (SEE B)  
 END PREP (SEE C)  
 TYPE (SEE D)

**(A) MATERIAL**

- A = Bronze End Piece (Titanium Ball) with Bronze Body
- B = Bronze End Piece (Cres Ball) with Bronze Body
- D = Nickel Copper End Piece (Titanium Ball) with Bronze Body
- E = Nickel Copper End Piece (Cres Ball) with Bronze Body
- M = Copper Nickel End Piece (Titanium Ball) with Bronze Body
- N = Copper Nickel End Piece (Cres Ball) with Bronze Body

**(B) SIZE:**

- 1 = 3"
- 2 = 3 1/2"
- 3 = 4"
- 4 = 5"
- 5 = 6"

**(C) END PREPARATION:**

- 1 = Butt Weld (SCH 40 for Nickel Copper or Class 700 for Copper Nickel End Pieces)
- 2 = Silver Braze

**(D) TYPE:**

- 1 = Straight

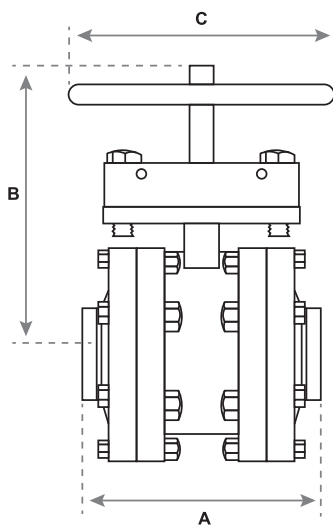
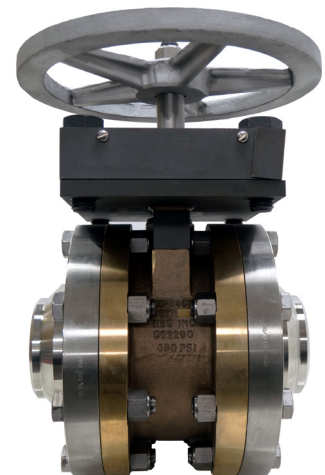

NOMINAL PIPE SIZE	RBS P/N	A Sil-Braze	A Butt Weld	B	C
4"	1004-ABCD	11.852	11.852	12.437	12
5"	1004-ABCD	11.852	11.852	12.437	12
6"	1004-ABCD		16.478	12.437	12

NOTES: For P/N replace **ABCD** with the correct Assembly Number codes.

End Preparation:

1. Butt Weld (SCH 40 or Class 700) in accordance to P-73 or MIL-STD-22
2. Silver Braze in accordance with NAVSHIPS 803-1385942

CRES Balls shall not be used in seawater applications.

Valves available with automated operators upon request.

