



Republic Brass Sales, Inc.
619.229.8304
6566 Federal Blvd
Lemon Grove, CA 91945
www.republicbrasssales.com

CONCENTRIC REDUCER BELLED END

Specification: DWG 802-5959353 / MSS-SP-119

Pressure Rating: 200 PSIG (WOG)

Intended for use with Class 200
Copper Nickel Tube IAW MIL-T-16420

SERVICE RATING TABLE		
Nominal Pipe Size (INCHES)	Maximum Working Pressure (LB/IN ²)	Maximum Temperature (°F)
1/4 through 12	200	150



90/10 CUNI
(ALLOY C70600)



70/30 CUNI
(ALLOY C71500)

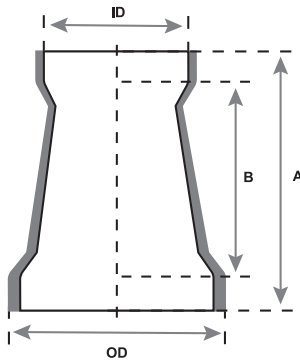

AVAILABLE ALLOYS: CUNI 90/10 & CUNI 70/30

NOMINAL PIPE SIZE	ID	OD MIN
1/4"	0.540	0.670
3/8"	0.675	0.805
1/2"	0.840	0.970
3/4"	1.050	1.180
1"	1.315	1.445
1 1/4"	1.660	1.804
1 1/2"	1.900	2.044
2"	2.375	2.541
2 1/2"	2.875	3.041
3"	3.500	3.690
3 1/2"	4.000	4.190
4"	4.500	4.718
5"	5.563	5.813
6"	6.625	6.893
8"	8.625	8.927
10"	10.750	11.124
12"	12.75	13.250

NOMINAL PIPE SIZE	RBS P/N (90/10)	RBS P/N (70/30)	A	B
3/8 x 1/4"	CR9BE060-040	CR7BE060-040	1.84	1.22
1/2 x 1/4"	CR9BE100-040	CR7BE100-040	1.9	1.27
1/2 x 3/8"	CR9BE100-060	CR7BE100-060	1.9	1.27
3/4 x 1/4"	CR9BE150-040	CR7BE150-040	1.9	1.27
3/4 x 3/8"	CR9BE150-060	CR7BE150-060	1.9	1.27
3/4 x 1/2"	CR9BE150-100	CR7BE150-100	1.9	1.27
1 x 1/4"	CR9BE200-040	CR7BE200-040	2.6	1.91
1 x 3/8"	CR9BE200-060	CR7BE200-060	2.6	1.91
1 x 1/2"	CR9BE200-100	CR7BE200-100	2.6	1.91
1 x 3/4"	CR9BE200-150	CR7BE200-150	2.6	1.91
1 1/4 x 1/4"	CR9BE250-040	CR7BE250-040	2.75	2
1 1/4 x 3/8"	CR9BE250-060	CR7BE250-060	2.75	2
1 1/4 x 1/2"	CR9BE250-100	CR7BE250-100	2.75	2
1 1/4 x 3/4"	CR9BE250-150	CR7BE250-150	2.75	2
1 1/4 x 1"	CR9BE250-200	CR7BE250-200	2.75	1.94
1 1/2 x 1/4"	CR9BE300-040	CR7BE300-040	3.37	2.5
1 1/2 x 3/8"	CR9BE300-060	CR7BE300-060	3.37	2.5

NOTES: Fittings may be ordered with reduced ends. Sizes not shown may be available upon request.
Dimension shown reflect NAVSEA DWG 802-5959353, App. B





Republic Brass Sales, Inc.
619.229.8304
6566 Federal Blvd
Lemon Grove, CA 91945
www.republicbrasssales.com

CONCENTRIC REDUCER BELLED END

Specification: DWG 802-5959353 / MSS-SP-119

Pressure Rating: 200 PSIG (WOG)

Intended for use with Class 200
Copper Nickel Tube IAW MIL-T-16420

SERVICE RATING TABLE		
Nominal Pipe Size (INCHES)	Maximum Working Pressure (LB/IN ²)	Maximum Temperature (°F)
1/4 through 12	200	150



90/10 CUNI
(ALLOY C70600)



70/30 CUNI
(ALLOY C71500)

AVAILABLE ALLOYS: CUNI 90/10 & CUNI 70/30

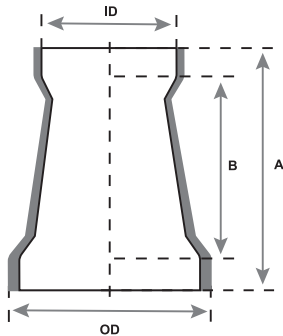

NOMINAL PIPE SIZE	ID	OD MIN
1/4"	0.540	0.670
3/8"	0.675	0.805
1/2"	0.840	0.970
3/4"	1.050	1.180
1"	1.315	1.445
1 1/4"	1.660	1.804
1 1/2"	1.900	2.044
2"	2.375	2.541
2 1/2"	2.875	3.041
3"	3.500	3.690
3 1/2"	4.000	4.190
4"	4.500	4.718
5"	5.563	5.813
6"	6.625	6.893
8"	8.625	8.927
10"	10.750	11.124
12"	12.75	13.250

NOMINAL PIPE SIZE	RBS P/N (90/10)	RBS P/N (70/30)	A	B
1 1/2 x 1/2"	CR9BE300-100	CR7BE300-100	3.37	2.5
1 1/2 x 3/4"	CR9BE300-150	CR7BE300-150	3.37	2.5
1 1/2 x 1"	CR9BE300-200	CR7BE300-200	3.37	2.44
1 1/2 x 1 1/4"	CR9BE300-250	CR7BE300-250	3.37	2.37
2 x 1/2"	CR9BE400-100	CR7BE400-100	3.84	2.97
2 x 3/4"	CR9BE400-150	CR7BE400-150	3.84	2.97
2 x 1"	CR9BE400-200	CR7BE400-200	3.84	2.9
2 x 1 1/4"	CR9BE400-250	CR7BE400-250	3.84	2.84
2 x 1 1/2"	CR9BE400-300	CR7BE400-300	3.84	2.72
2 1/2 x 1"	CR9BE450-200	CR7BE450-200	4.34	3.15
2 1/2 x 1 1/4"	CR9BE450-250	CR7BE450-250	4.34	3.15
2 1/2 x 1 1/2"	CR9BE450-300	CR7BE450-300	4.34	3.03
2 1/2 x 2"	CR9BE450-400	CR7BE450-400	4.34	3.03
3 1/2 x 1 1/2"	CR9BE350-300	CR7BE350-300	5.25	3.78
3 1/2 x 2"	CR9BE350-400	CR7BE350-400	5.25	3.78
3 1/2 x 2 1/2"	CR9BE350-450	CR7BE350-450	5.25	3.59
3 1/2 x 3"	CR9BE350-500	CR7BE350-500	5.25	3.59
4 x 2"	CR9BE600-400	CR7BE600-400	5.25	3.87
4 x 2 1/2"	CR9BE600-450	CR7BE600-450	5.25	3.69

NOTES: Fittings may be ordered with reduced ends.
Sizes not shown may be available upon request.
Dimension shown reflect NAVSEA DWG 802-5959353, App. B





Republic Brass Sales, Inc.
619.229.8304
6566 Federal Blvd
Lemon Grove, CA 91945
www.republicbrasssales.com

CONCENTRIC REDUCER BELLED END

Specification: DWG 802-5959353 / MSS-SP-119

Pressure Rating: 200 PSIG (WOG)

Intended for use with Class 200
Copper Nickel Tube IAW MIL-T-16420

SERVICE RATING TABLE		
Nominal Pipe Size (INCHES)	Maximum Working Pressure (LB/IN ²)	Maximum Temperature (°F)
1/4 through 12	200	150



90/10 CUNI
(ALLOY C70600)



70/30 CUNI
(ALLOY C71500)

AVAILABLE ALLOYS: CUNI 90/10 & CUNI 70/30

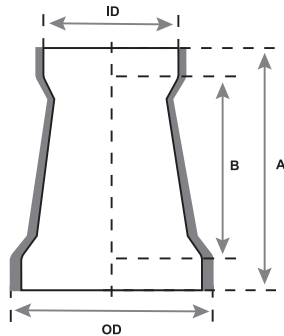

NOMINAL PIPE SIZE	ID	OD MIN
1/4"	0.540	0.670
3/8"	0.675	0.805
1/2"	0.840	0.970
3/4"	1.050	1.180
1"	1.315	1.445
1 1/4"	1.660	1.804
1 1/2"	1.900	2.044
2"	2.375	2.541
2 1/2"	2.875	3.041
3"	3.500	3.690
3 1/2"	4.000	4.190
4"	4.500	4.718
5"	5.563	5.813
6"	6.625	6.893
8"	8.625	8.927
10"	10.750	11.124
12"	12.75	13.250

NOMINAL PIPE SIZE	RBS P/N (90/10)	RBS P/N (70/30)	A	B
4 x 3"	CR9BE600-500	CR7BE600-500	5.25	3.69
4 x 3 1/2"	CR9BE600-550	CR7BE600-550	5.25	3.66
5 x 2 1/2"	CR9BE700-450	CR7BE700-450	6.32	4.63
5 x 3"	CR9BE700-500	CR7BE700-500	6.32	4.63
5 x 3 1/2"	CR9BE700-550	CR7BE700-550	6.32	4.66
5 x 4"	CR9BE700-600	CR7BE700-600	6.32	4.57
6 x 2 1/2"	CR9BE800-450	CR7BE800-450	6.8	5.12
6 x 3"	CR9BE800-500	CR7BE800-500	6.8	5.05
6 x 3 1/2"	CR9BE800-550	CR7BE800-550	6.8	5.02
6 x 4"	CR9BE800-600	CR7BE800-600	6.8	4.99
6 x 5"	CR9BE800-700	CR7BE800-700	6.8	4.86
8 x 4"	CR9BE900-600	CR7BE900-600	7.45	5.39
8 x 5"	CR9BE900-700	CR7BE900-700	7.45	5.26
8 x 6"	CR9BE900-800	CR7BE900-800	7.45	5.2
10 x 5"	CR9BE1000-700	CR7BE1000-700	8.75	6.38
10 x 6"	CR9BE1000-800	CR7BE1000-800	8.75	6.32
10 x 8"	CR9BE1000-900	CR7BE1000-900	8.75	6.06
12 x 6"	CR9BE1000-800	CR7BE1000-800	9.87	7.31
12 x 8"	CR9BE1100-900	CR7BE1100-900	9.87	7.06
12 x 10"	CR9BE1100-1000	CR7BE1100-1000	9.87	6.87

NOTES: Fittings may be ordered with reduced ends.
Sizes not shown may be available upon request.
Dimension shown reflect NAVSEA DWG 802-5959353, App. B

