



Republic Brass Sales, Inc.
 619.229.8304
 6566 Federal Blvd
 Lemon Grove, CA 91945
 www.republicbrasssales.com

CROSS BUTT WELD

Specification: NAVSEA DWG 810-1385880
 Pressure Rating: 200 PSIG (WOG)

Intended for use with Class 200
 Copper Nickel Tube IAW MIL-T-16420

SERVICE RATING TABLE		
Nominal Pipe Size (INCHES)	Maximum Working Pressure (LB/IN ²)	Maximum Temperature (°F)
1/4 through 12	200	150



90/10 CUNI
(ALLOY C70600)



70/30 CUNI
(ALLOY C71500)

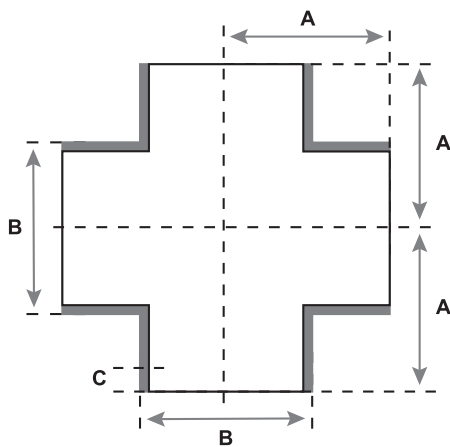

AVAILABLE ALLOYS: CUNI 90/10 & CUNI 70/30

NOMINAL PIPE SIZE	RBS P/N (90/10)	RBS P/N (70/30)	A	B	C MIN
1/4"	CRO9BW040	CRO7BW040	0.69	0.540	0.28
3/8"	CRO9BW060	CRO7BW060	0.91	0.675	0.38
1/2"	CRO9BW100	CRO7BW100	1.09	0.840	0.44
3/4"	CRO9BW150	CRO7BW150	1.25	1.050	0.47
1"	CRO9BW200	CRO7BW200	1.50	1.315	0.50
1 1/4"	CRO9BW250	CRO7BW250	1.88	1.660	0.56
1 1/2"	CRO9BW300	CRO7BW300	2.25	1.900	0.69
2"	CRO9BW400	CRO7BW400	2.50	2.375	0.72
2 1/2"	CRO9BW450	CRO7BW450	3.00	2.875	0.88
3"	CRO9BW500	CRO7BW500	3.38	3.500	0.91
3 1/2"	CRO9BW550	CRO7BW550	3.75	4.000	0.94
4"	CRO9BW600	CRO7BW600	4.13	4.500	0.97
5"	CRO9BW700	CRO7BW700	4.88	5.563	1.09
6"	CRO9BW800	CRO7BW800	5.63	6.625	1.17
8"	CRO9BW900	CRO7BW900	7.00	8.625	1.38
10"	CRO9BW1000	CRO7BW1000	8.50	10.750	1.56
12"	CRO9BW1100	CRO7BW1100	10.00	12.750	1.69

EDGE PREPARATION FOR WELDING

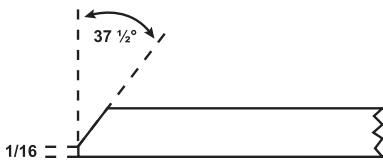

Square edge for 0.095 wall or lighter.
 For heavier than 0.095 wall, beveled as shown.

NOTES: Fittings may be ordered with reduced ends.
 Sizes not shown may be available upon request.

