



Republic Brass Sales, Inc.
 619.229.8304
 6566 Federal Blvd
 Lemon Grove, CA 91945
 www.republicbrasssales.com

LONG TURN DOUBLE SWEEP TEE BUTT WELD

Specification: NAVSEA DWG 810-1385880
 Pressure Rating: 200 PSIG (WOG)

Intended for use with Class 200
 Copper Nickel Tube IAW MIL-T-16420

SERVICE RATING TABLE		
Nominal Pipe Size (INCHES)	Maximum Working Pressure (LB/IN ²)	Maximum Temperature (°F)
1/4 through 12	200	150



90/10 CUNI
 (ALLOY C70600)



70/30 CUNI
 (ALLOY C71500)

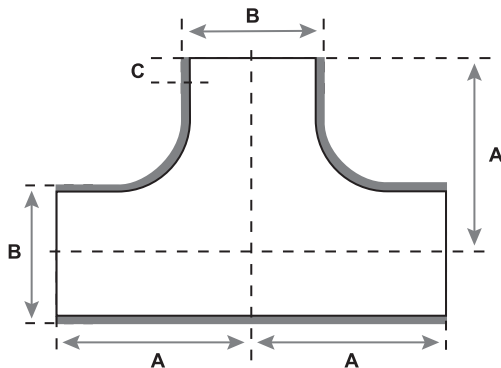

AVAILABLE ALLOYS: CUNI 90/10 & CUNI 70/30

NOMINAL PIPE SIZE	RBS P/N (90/10)	RBS P/N (70/30)	A	B	C MIN
1 1/4"	DST9BW250	DST7BW250	2.44	1.660	0.56
1 1/2"	DST9BW300	DST7BW300	2.94	1.900	0.69
2"	DST9BW400	DST7BW400	3.72	2.375	0.72
2 1/2"	DST9BW450	DST7BW450	4.63	2.875	0.88
3"	DST9BW500	DST7BW500	5.41	3.500	0.91
3 1/2"	DST9BW550	DST7BW550	6.25	4.000	0.94
4"	DST9BW600	DST7BW600	6.97	4.500	0.97
5"	DST9BW700	DST7BW700	8.59	5.563	1.09
6"	DST9BW800	DST7BW800	10.17	6.625	1.17
8"	DST9BW900	DST7BW900	13.38	8.625	1.38

EDGE PREPARATION FOR WELDING

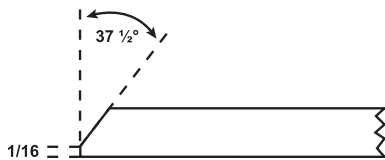

Square edge for 0.095 wall or lighter.
 For heavier than 0.095 wall, beveled as shown.

NOTES: Fittings may be ordered with reduced ends. Sizes not shown may be available upon request.

