



Republic Brass Sales, Inc.
619.229.8304
6566 Federal Blvd
Lemon Grove, CA 91945
www.republicbrasssales.com

LONG TURN DOUBLE SWEEP TEE SOCKET WELD

Specification: NAVSEA DWG 803-6397430
Pressure Rating: 400 PSIG (WOG)

Intended for use with Class 200 or 700
Copper Nickel Tube IAW MIL-T-16420

SERVICE RATING TABLE				
Nominal Pipe Size (INCHES)	Maximum Working Pressure (LB/IN ²)	Maximum Temperature (°F)	Maximum Working Pressure (LB/IN ²)	Maximum Temperature (°F)
1/4 through 6	200	425	400	150
Above 6	150	425	250	150



70/30 CUNI
(ALLOY C715/C964)



90/10 CUNI
(ALLOY C706/C962)

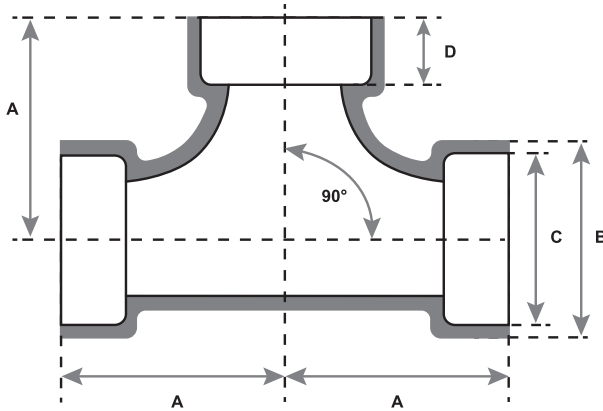

AVAILABLE ALLOYS: CUNI 90/10 & CUNI 70/30

NOMINAL PIPE SIZE	1/4"	3/8"	1/2"	3/4"	1"	1 1/4"	1 1/2"	2"	2 1/2"	3"	3 1/2"	4"
RBS P/N (90/10)	DST9SW040	DST9SW060	DST9SW100	DST9SW150	DST9SW200	DST9SW250	DST9SW300	DST9SW400	DST9SW450	DST9SW500	DST9SW550	DST9SW600
RBS P/N (70/30)	DST7SW040	DST7SW060	DST7SW100	DST7SW150	DST7SW200	DST7SW250	DST7SW300	DST9SW400	DST7SW450	DST7SW500	DST7SW550	DST7SW600
A	1.250	1.500	1.750	2.000	2.310	2.750	3.130	3.750	4.500	5.440	6.190	6.940
B	0.945	1.096	1.275	1.503	1.780	2.129	2.387	2.908	3.408	4.041	4.541	5.097
C	.545 (+/- .030)	.680 (+/- .030)	.845 (+/- .030)	1.055 (+/- .030)	1.320 (+/- .030)	1.665 (+/- .030)	1.905 (+/- .030)	2.380 +/- .046	2.880 (+/- .051)	3.505 (+/- .055)	4.005 (+/- .055)	4.505 (+/- .060)
D	25/94	5/16	3/8	13/32	7/16	1/2	5/8	23/35	25/32	77/93	7/8	29/32

NOTES: Fittings may be ordered with reduced ends and/or female threads.

