



Republic Brass Sales, Inc.  
 619.229.8304  
 6566 Federal Blvd  
 Lemon Grove, CA 91945  
 www.republicbrasssales.com

# UNION ASSEMBLY

## SOCKET WELD

Specification: NAVSEA DWG 803-6397430

Pressure Rating: 400 PSIG (WOG)

Intended for use with Class 200 or 700  
 Copper Nickel Tube IAW MIL-T-16420

SERVICE RATING TABLE				
Nominal Pipe Size (INCHES)	Maximum Working Pressure (LB/IN <sup>2</sup> )	Maximum Temperature (°F)	Maximum Working Pressure (LB/IN <sup>2</sup> )	Maximum Temperature (°F)
1/4 through 6	200	425	400	150
Above 6	150	425	250	150



70/30 CUNI  
(ALLOY C715/C964)

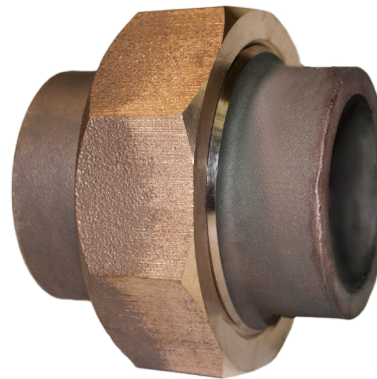

90/10 CUNI  
(ALLOY C706/C962)

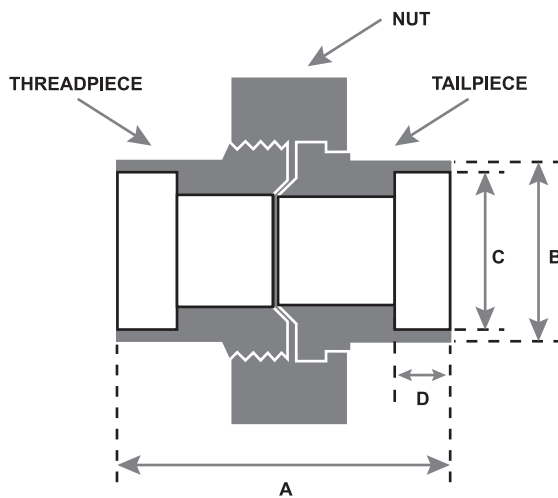

### AVAILABLE ALLOYS: CUNI 90/10 & CUNI 70/30

NOMINAL PIPE SIZE	1/4"	3/8"	1/2"	3/4"	1"	1 1/4"	1 1/2"	2"
RBS P/N (90/10)	U9SW040	U9SW060	U9SW100	U9SW150	U9SW200	U9SW250	U9SW300	U9SW400
RBS P/N (70/30)	U7SW040	U7SW060	U7SW100	U7SW150	U7SW200	U7SW250	U7SW300	U7SW400
A	1 5/8	1 13/16	1 15/16	2 1/4	2 7/16	2 13/16	3	3 3/8
B	.828 (+/- .015)	.984 (+/- .015)	1.188 (+/- .015)	1.468 (+/- .015)	1.750 (+/- .015)	2.125 (+/- .015)	2.375 (+/- .015)	2.906 (+/- .015)
C	.545 (-.000 /+ .030)	.680 (-.000 /+ .030)	.845 (-.000 /+ .030)	1.055 (-.000 /+ .030)	1.320 (-.000 /+ .030)	1.665 (-.000 /+ .030)	1.905 (-.000 /+ .030)	2.380 (-.000 /+ .046)
D	17/64	5/16	3/8	13/32	7/16	1/2	5/8	21/32

NOTES: Fittings may be ordered with reduced ends and/or female threads

